

## MAGIC CORNER STANDARD CORNER PULL - OUT

- Soft opening and soft - opening mechanism
- Ergonomic access to all of the unit's contents
- Easy assembly
- Available size > 600 mm
- Finishes > Anthracite



type left



The shelves and fittings

The simple solution that helps you make best use of space in corner units.

### DISTINGUISHING FEATURES:



- Just swing the front panel and the front shelves to one side and the back shelves automatically slide forwards
- Ideal for storing tableware and groceries



- Access to the full contents of your units
- Integrated Softclose soft- closing mechanism
- All shelves can easily be removed for cleaning and clipped back into place

### OPTIONS



**Divider**  
Magnetic dividers are a flexible way for you to organise your shelf space

### Finishes available: Anthracite

- for 550 / 600 mm door width ( 300.0817.43 ) left
- for 550 / 600 mm door width ( 300.0814.43 ) right

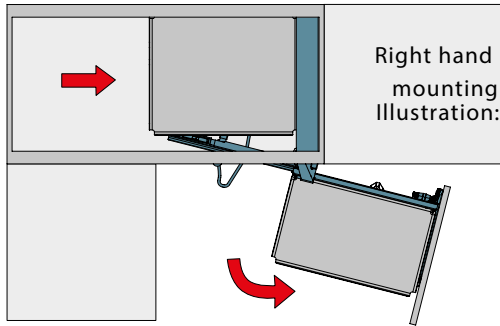
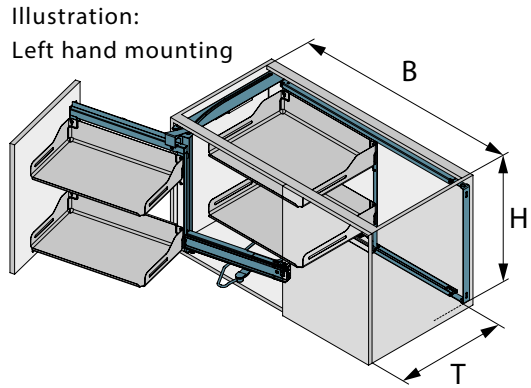
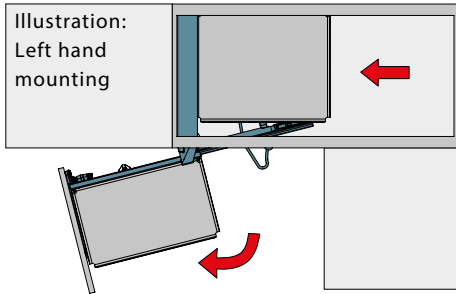

B= Interior width	960 / 1071 mm
T= Interior depth	500 mm
H= Interior height	535 mm