

- Most compact and space-efficient solution for narrow units thanks to thin-walled shelves and full use of unit height
- A single movement brings the entire contents out in front of the unit
- Complete overview and easy access, including at the top (above head height)
- Very easy to open, even when fully loaded
- Shelves can be easily removed for cleaning and clipped back in place
- Extra shelves can be retrofitted at any time without tools
- Suitable for compact living and barrier-free homes
- Optional accessories allowing customised use of shelf space





TECHNICAL CHARACTERISTICS

- ➔ Clip-on shelves can be positioned as required
- ➔ Extension runner with a high load capacity of 100 / 120 kg
- ➔ Built-in Softopen and Softclose mechanisms ensure that the unit can be opened and closed smoothly and silently
- ➔ Mounted on base and top, making it suitable for all unit widths and depths
- ➔ Suitable for all standard widths from 150 mm to 450 mm
- ➔ Automatic synchronization in the pull-out ensures that the cabinet always closes perfectly
- ➔ Also suitable for framed fronts
- ➔ Height-adjustable tubular frame and platform strategy ensure design/planning flexibility and ease of warehousing
- ➔ Suitable for heights between 900 mm and 2,260 mm
- ➔ Can be retrofitted without production infrastructure, as no shelves have to be produced
- ➔ Ideal as a space filler, for example as thermal insulation between the oven and fridge

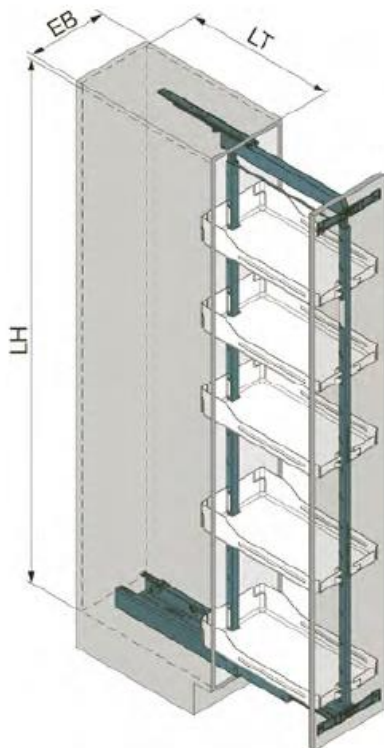

STANDARD SINGLE RUNNER 150MM

Colour	Interior width min. (LB) mm	Interior depth min. (LT) mm
Anthracite	112	505



TUBULAR FRAME

Colour	Interior height min. (LH) mm
Anthracite	1805-2260



FULL COMPACT RUNNER 300MM

Colour	Interior width min. (LB) mm	Interior depth min. (LT) mm
Anthracite	162	505