

LIBRA

LIBRA H1 Cabinet hanger

- Universal screw fixing cabinet hanger
- Vertically and horizontally adjustable
- Integrated ANTI-TURNOVER device
- Load capacity per piece > 75KG



LIBRA H1 cabinet hanger



LIBRA WP1 Wall Plate



LIBRA CC1 Cover Caps



Libra is the innovative family of the CABINET HANGERS and WALL PLATES especially conceived to satisfy all the customer's needs. The LIBRA hangers are to be installed behind the rear panel with the small cover caps left visible inside the cabinet. LIBRA is a very resistant and reliable solutions as the zinc-coated steel body is sensibly thicker, and therefore stronger. All the models within the LIBRA family feature an innovative ANTI-TURNOVER device which is covered by patent.

Also featured in the LIBRA family is the wall bar made of very thick zinc-coated steel and hardened by punched impressions. Wall bars feature oval holes which facilitate the correct positioning and give the possibility to carry out the horizontal adjustment.

LIBRA H1 is the universal screw fixing cabinet hanger. LIBRA cabinet hangers allow to adjust the cabinet vertically and horizontally. The 2 movements are 100% INDEPENDENT of each other and therefore make the adjustments much easier and more efficient.

The adjustment and the locking of the ANTI-TURNOVER bolt can be carried out from the inside of the cabinet by using a standard PZ2 screwdriver.

DRILLING PLAN FOR CABINET HANGER FIXED UNDER THE CABINET TOP

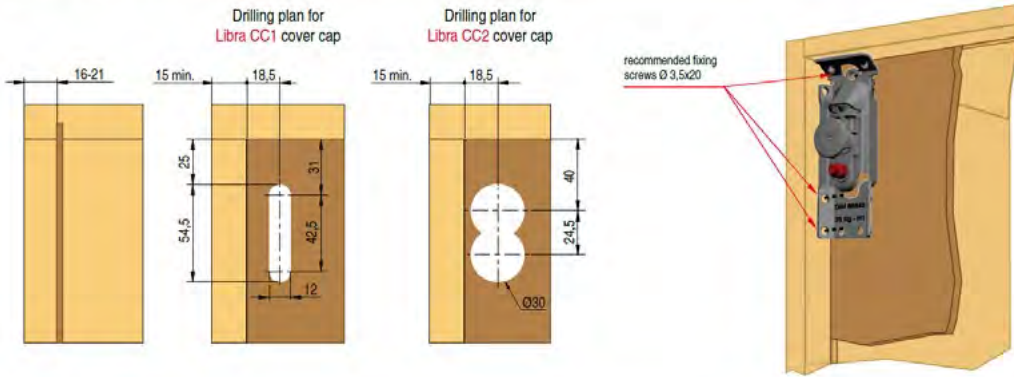

OTHER APPLICATIONS FOR CABINET HANGER NOT FIXED TO THE TOP

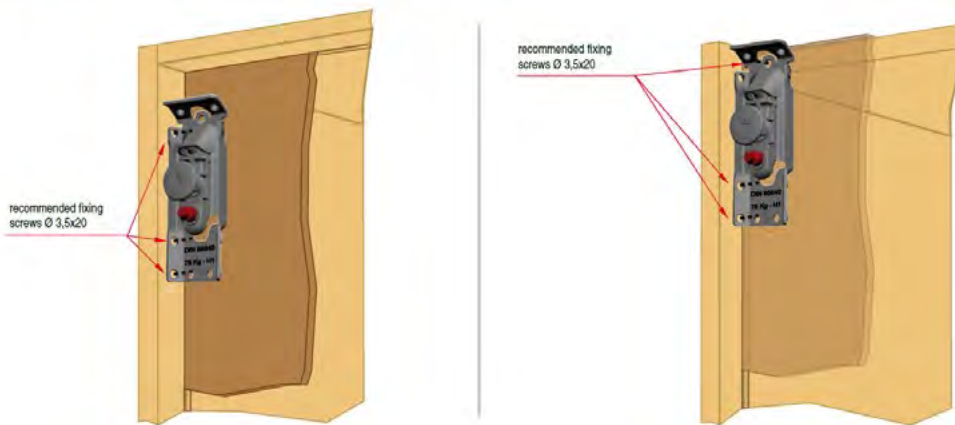

Adjustments

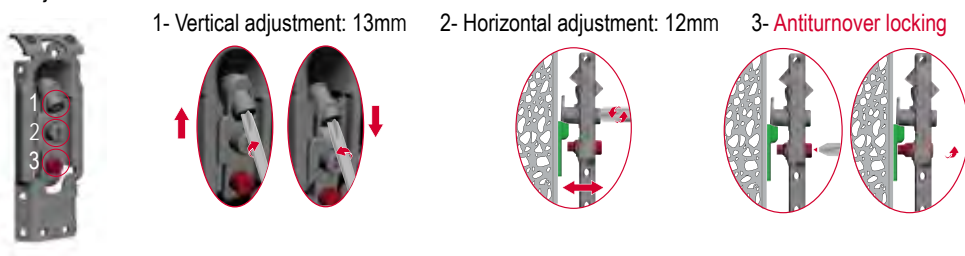

Installations

